

INSTRUCTION

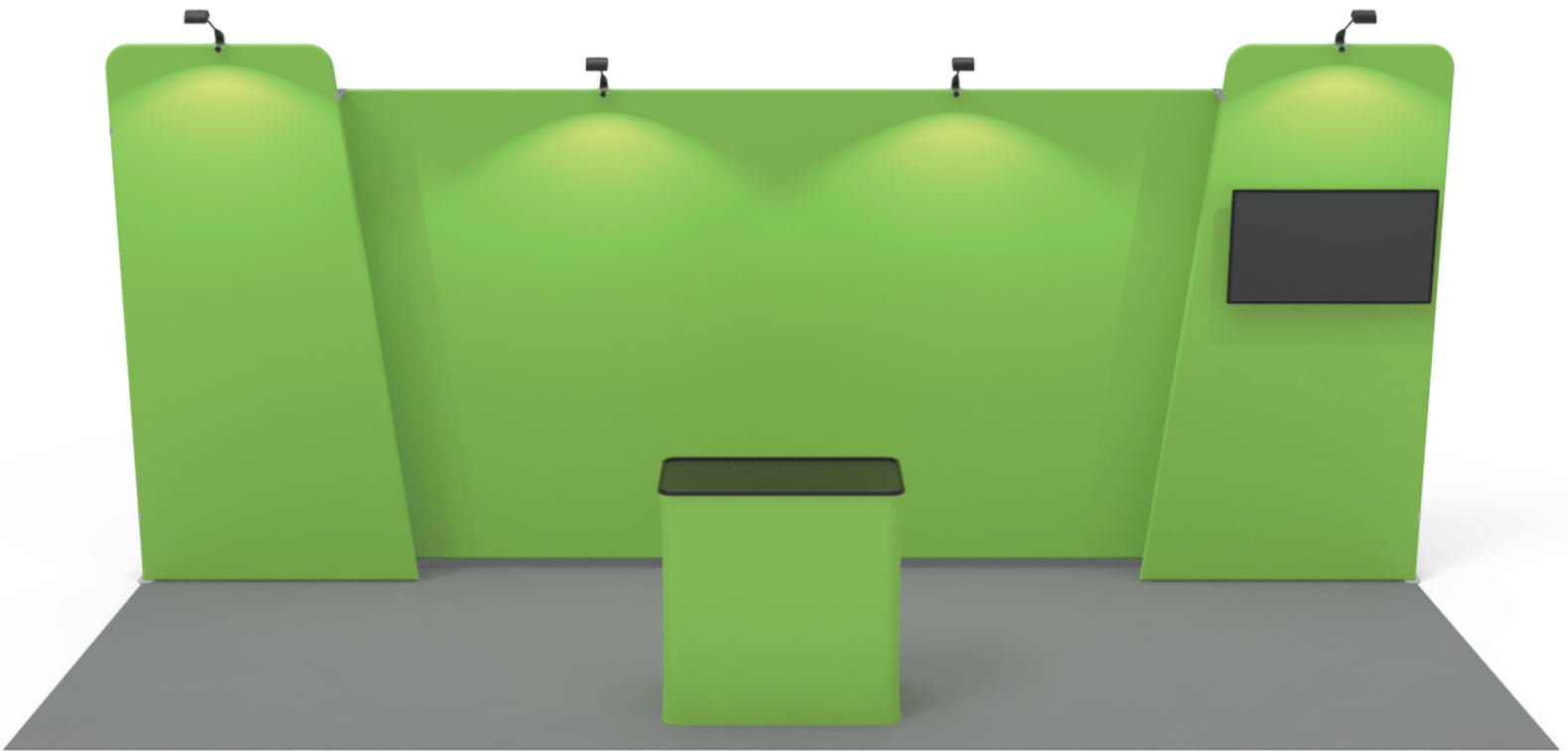

10X20FT-BOOTH-29

STEPS

(1) Hardware

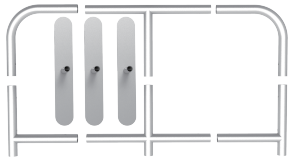

x3



x4

(2) Printed Graphic Fabric Banner (Optional)



STEP 01

Connect to make long poles according to labelings.



x3



x4

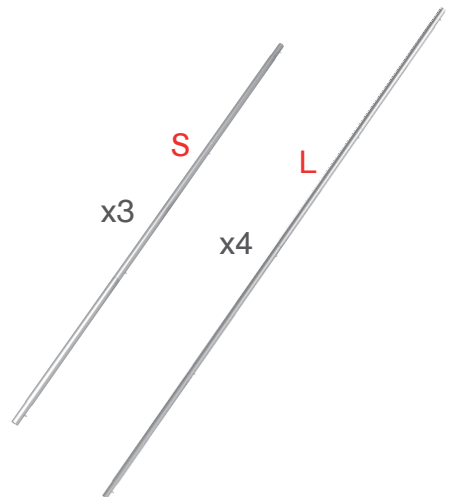
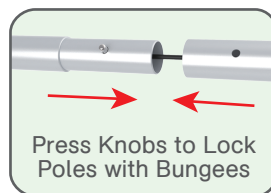

STEP 02

Connect long poles with corner poles according to labelings.

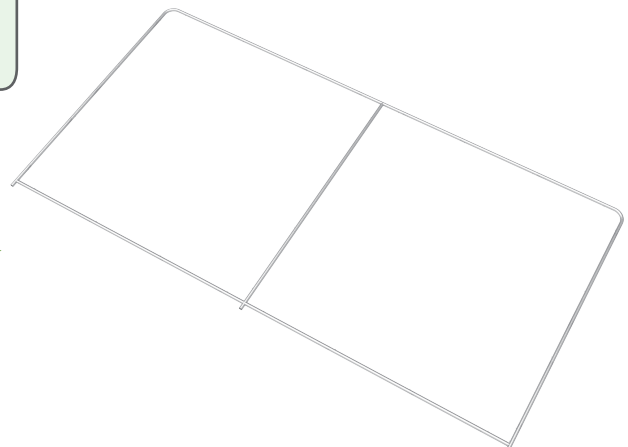
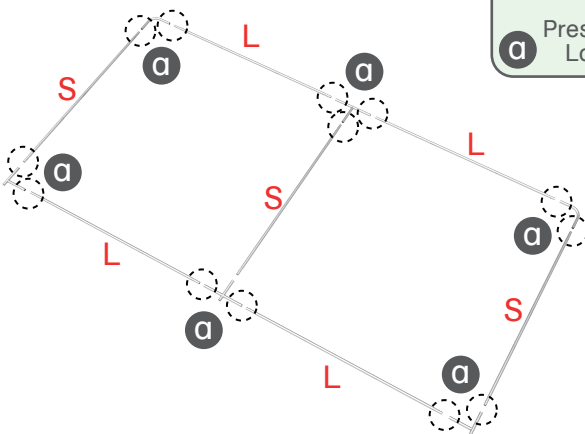
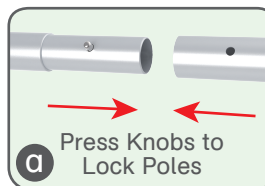

STEPS

STEP 03

Slide fabric banner on frame from top and zip up at bottom.

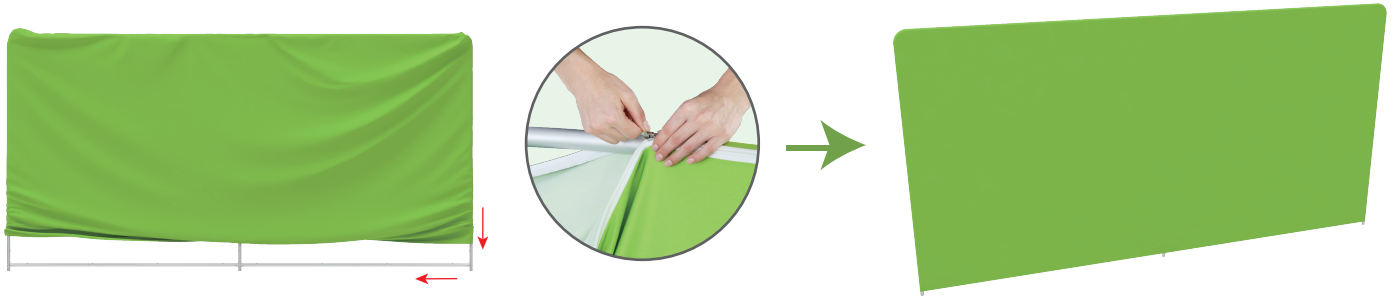

STEP 04

Insert display stands onto feet by pressing their knobs.

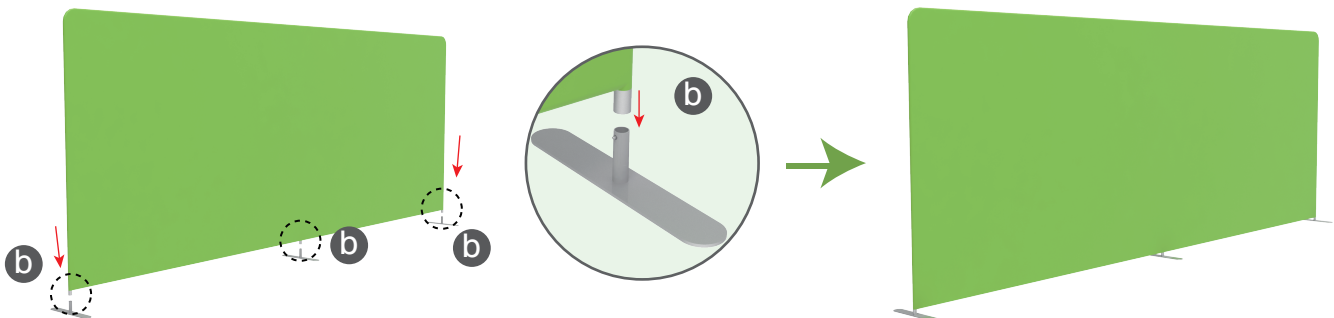

(1) Hardware

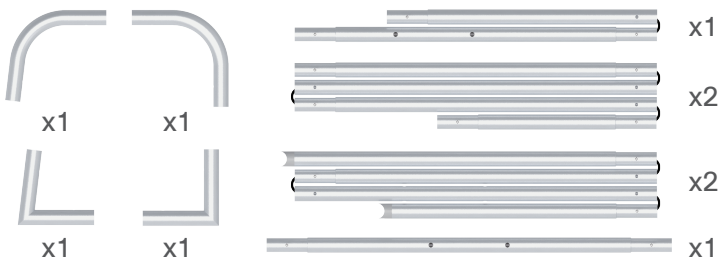

(2) Printed Graphic Fabric Banner (Optional)



STEP 01

Connect to make long poles according to labelings.

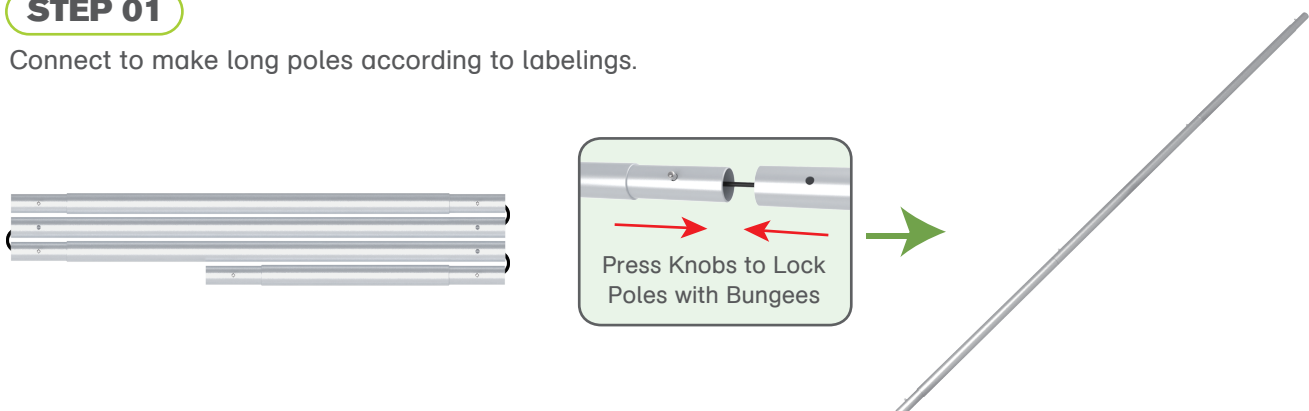

STEPS

STEP 02 Connect long poles with corner poles according to labelings.

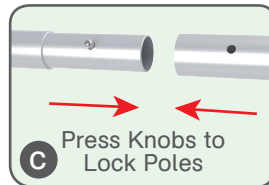
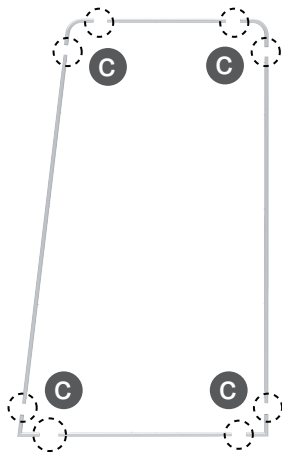

STEP 03 Connect intermediate tubes.

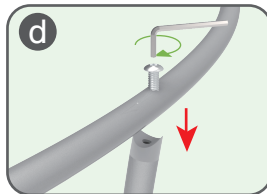

STEP 04 Slide fabric banner on frame from top and zip up at bottom.

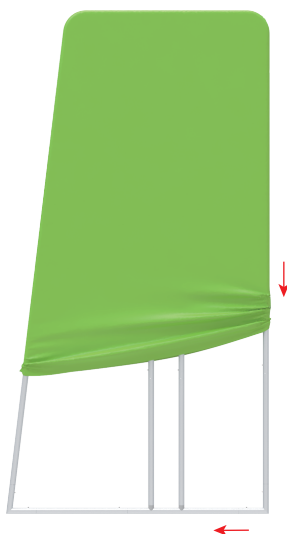

STEPS

Booth Set Assembly

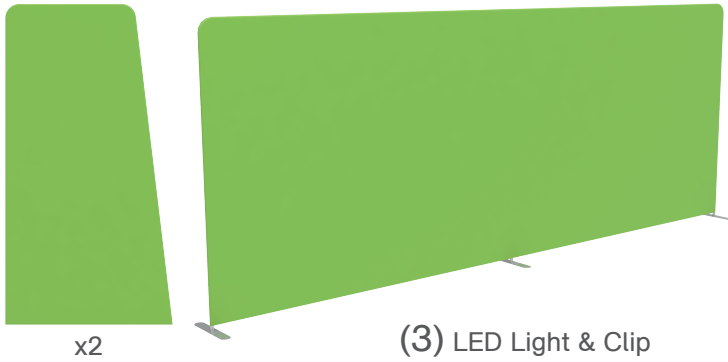

(3) LED Light & Clip



(1) TV Mount & Screw

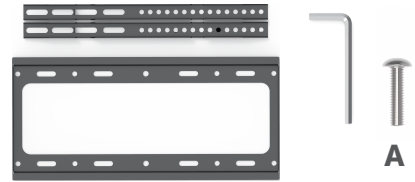

(2) Arm Clip



STEP 01

Connect display stands with arm clips.

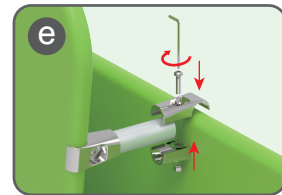

STEPS

STEP 02

Screw TV mount with hex wrench.

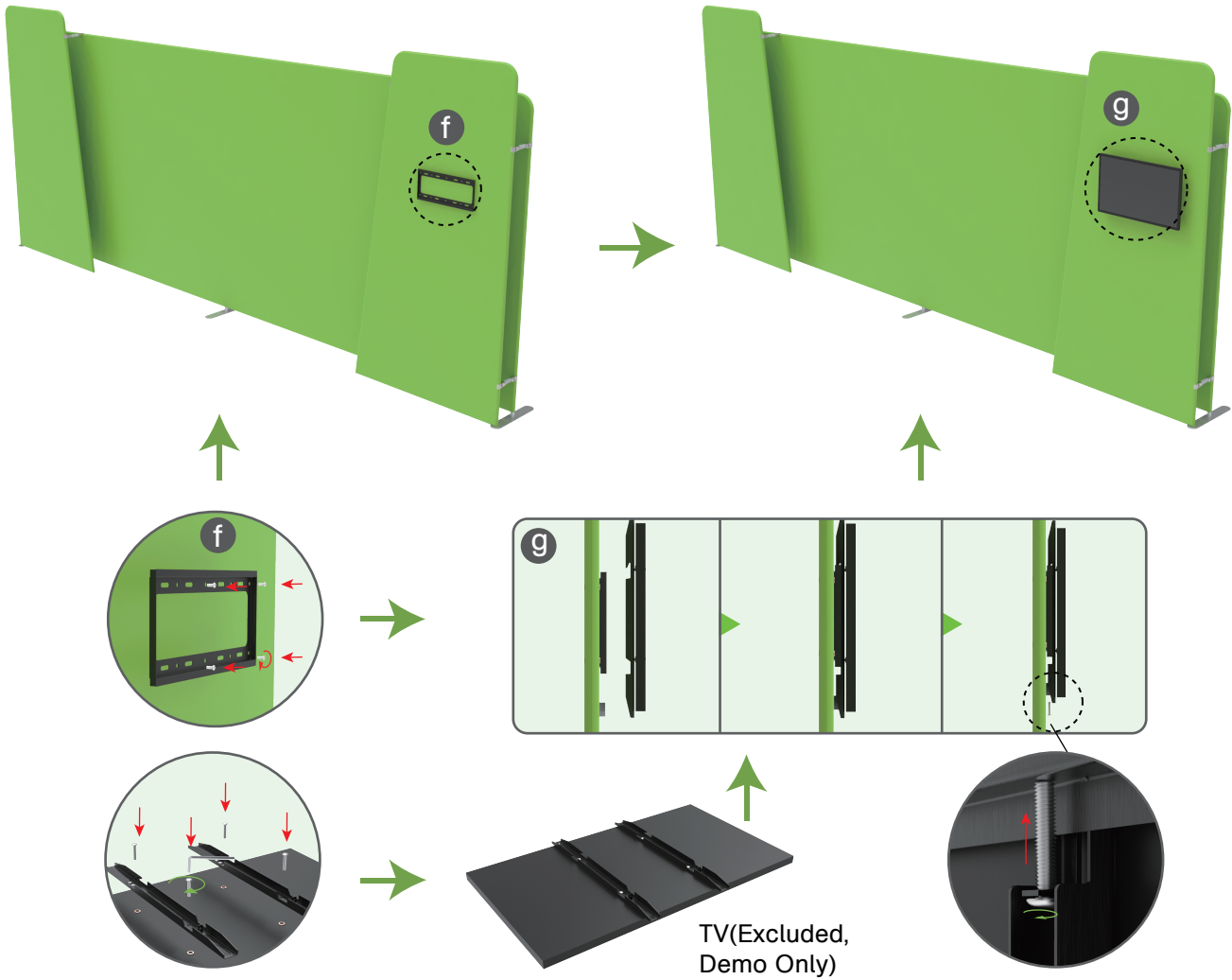

STEP 03

Screw light clips at top of display stands, slide lights onto them and adjust their direction.

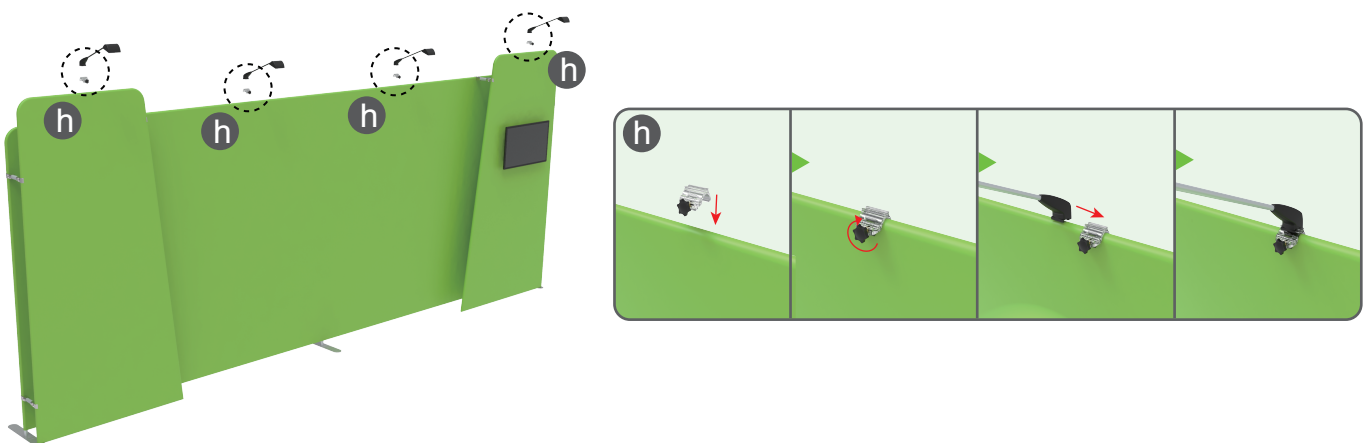

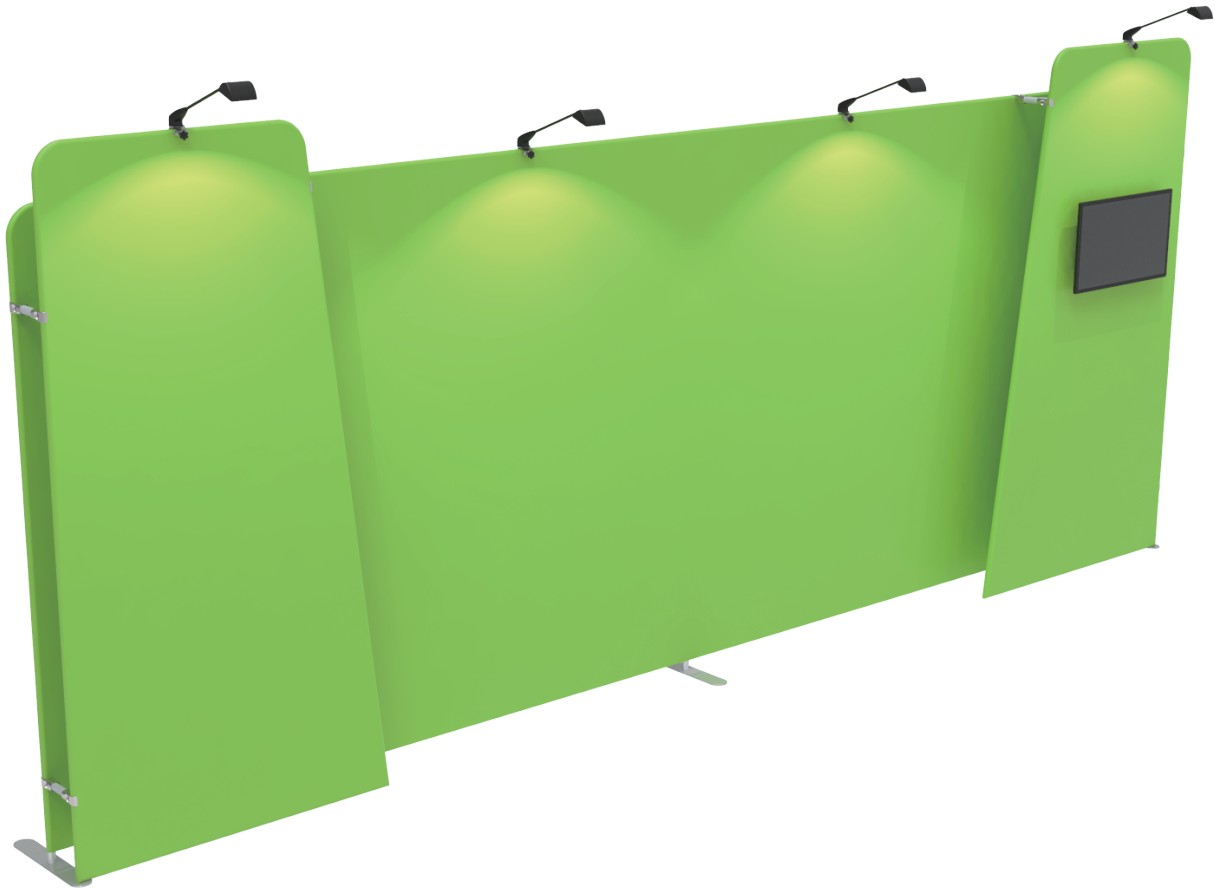
STEPS**10X20FT-BOOTH-29**

STEPS

(1) Durable Plastic Hard Case, Aluminum Support Poles



(2) Printed Graphic Fabric Banner



STEP 01

Put hard case's top into fabric banner.

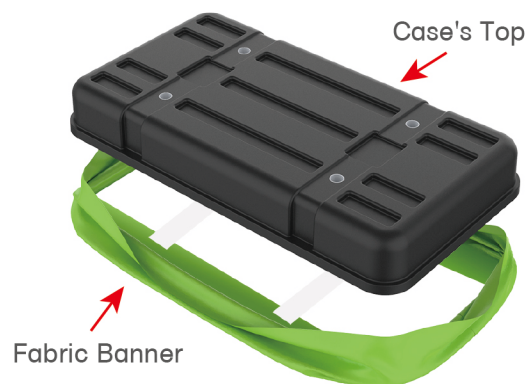

STEP 02

Insert support poles into hard case's top & bottom.

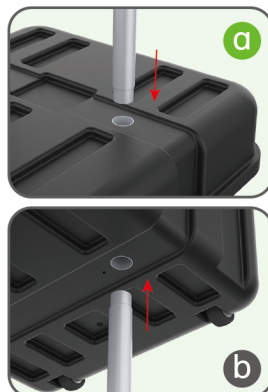
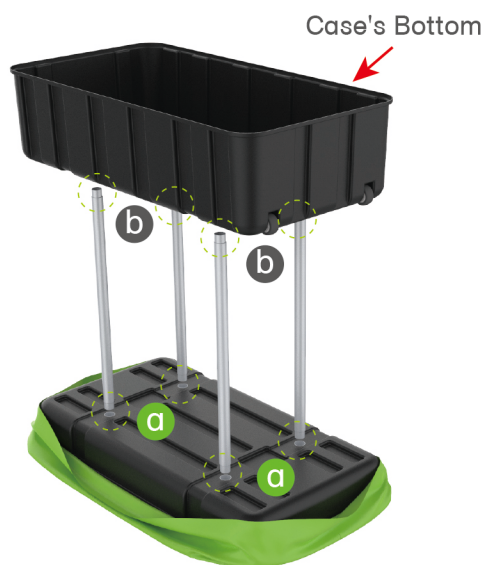

STEPS

STEP 04

Wrap fabric banner from bottom to top & twist it to be smooth, lay hard case's intermediate panel on podium's top.

